



# QUILT & Fabric Art FESTIVAL

**September 27-29, 2019**

Hundreds of Quilts: Traditional, Modern, and Fabric Art  
*Professional Judging and Awards*

Vendors • Demos • Free Lectures • Special Exhibits

Country Store with Handmade Items • Silent Auction

Workshops: Quilting and Surface Design

*Signups may still be available, see page 3.*

## **Featured Artist**

### **SANDRA MOLLON**

Be sure to take a close look at the fine details of Sandra's work and don't miss her free lecture on Sunday. See page 4 for details.

### **Lots of Raffle Prizes!**

- Boutique Items
- Door Prizes
- Opportunity Quilt
- Empty Spools Session at Asilomar

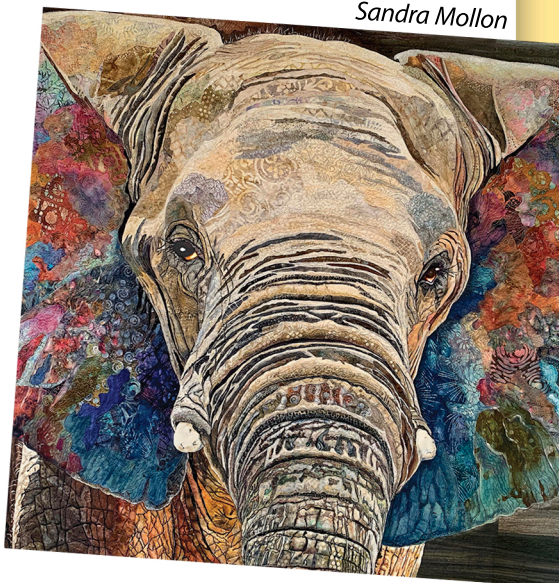

*Sandra Mollon*

## **River City Quilters' Guild**

Sacramento, CA

[www.QuiltandFabricArtFestival.com](http://www.QuiltandFabricArtFestival.com)

## TABLE OF CONTENTS

Demonstrations .....	7
Display Codes .....	10
Empty Spools Seminar Raffle .....	5
Featured Artist: Sandra Mollon .....	4
Judging Information .....	10
Map and Workshop Locations .....	2
Opportunity Drawings .....	5
Quilt List.....	11
Quilt Maker List .....	8
Vendors and Special Exhibits .....	6
Workshops and Lectures .....	3 and 4

*Information is subject to change. Photography is only allowed for personal use. Commercial photography is NOT allowed.*

## Thank you to our special supporters!

### **Fabric Garden**

[www.fabricgardenquiltshop.com](http://www.fabricgardenquiltshop.com)

### **Martelli Enterprises**

[www.martellinotions.com](http://www.martellinotions.com)

### **Meissner Sewing and Vacuum Center**

[www.meissnersewing.com](http://www.meissnersewing.com)

### **Quilters' Corner**

[www.quilterscornersac.com](http://www.quilterscornersac.com)

### **Swiftly Stitches**

[www.swiftystitches.com](http://www.swiftystitches.com)

### **Thistle Dew Quilt Shoppe**

[www.thistledewquiltshoppe.com](http://www.thistledewquiltshoppe.com)

## *New Meeting Location*

You are invited to join the guild or attend our general meetings for a \$5 guest fee held at the Mosaic Law Congregation, 2300 Sierra Blvd., Sacramento, CA 95825 (Free Parking).



## **River City Quilters' Guild**

[www.rivercityquilters.org](http://www.rivercityquilters.org)

# MAP

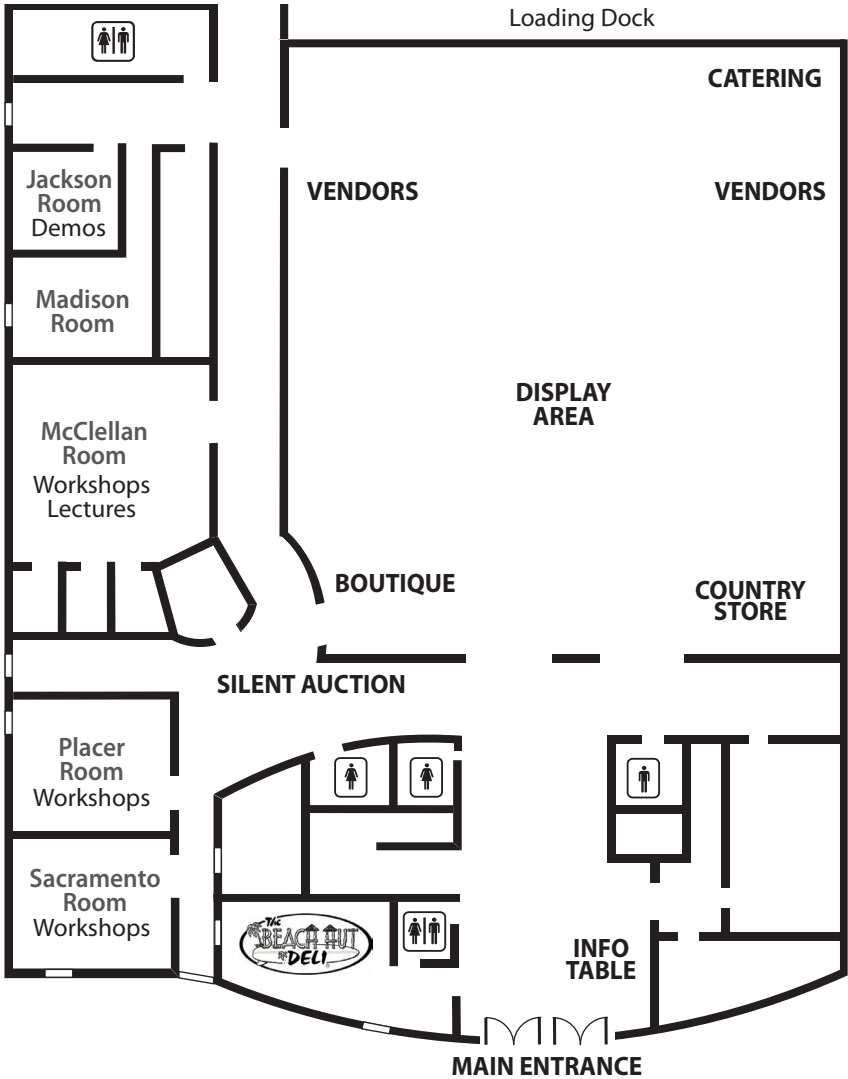

## WORKSHOP AND LECTURE LOCATIONS

	McClellan Room	Placer Room	Sacramento Room
<b>Thursday</b>	Rami Kim		Angelina McKenna
<b>Friday</b>	Laurel Anderson	Judy Coates Perez	Jane Haworth
<b>Saturday</b>	Jenny Lyon	Judy Coates Perez	Kim Brownell Kellie Willey
<b>Sunday</b>	Sandra Mollon Kim Brownell Kellie Willey	April Sproule	

## WORKSHOPS

Pre-registration was required for most workshops, however, there may still be space available. Sewing machines are supplied by Meissner's Sewing and Vacuum Center. Workshops are full day unless noted. **Late registration and supply lists are available at the Information Table in the entry area.**

### Thursday, September 26

Rami Kim: The Fifth Dimension

Angelina McKenna: Hands and Feet: Modern Approach to Traditional Quilting

### Friday, September 27

Laurel Anderson: Stashbuster: Showcase Pattern

Judy Coates Perez: Color Theory

Jane Haworth: Love of Pets Fabric Collage

### Saturday, September 28

Kim Brownell: Refillable Notebook Cover (Half Day, setup at 8:30 a.m.)

Judy Coates Perez: Painting Imagery on Fabric with Textile Paints

Jenny Lyon: Fearless Free Motion, Start with a Square

Kellie Willey: Teeny Tiny Basket Card (Half Day, setup at 12:30 p.m.)

### Sunday, September 29

April Sproule: Painted Textile Mandalas

## FREE LECTURES ON SUNDAY

Special lectures are included with your Festival admission.

Pre-registration not required, space available. Lectures are held in the McClellan Room, space available.

11:30 a.m. – 12:30 p.m.

**Kim Brownell** "Challenges: What To Do?"

*Learn good ideas on how to approach challenges, where to find them, and why everyone should participate in them.*

**Kellie Willey** "Little Quilts, No Big Deal!"

*Kellie will share what she's learned about making small scale quilts and help you feel confident enough to create your own.*

1:30 – 2:30 p.m.

**Sandra Mollon** "The Use of Textured Fabrics and Embellishment"

*See page 4 for the description of this lecture.*

## FEATURED ARTIST: SANDRA MOLLON

Our featured artist, Sandra Mollon, is an award winning quilter who has shown her work at international and regional juried shows. Sandra and her quilting partner, Kris Spray, won a major purchase award at the 2019 Spring Paducah Quilt Show for "Seasons of Life", which means that the quilt will be in the permanent collection of the National Quilt Museum!

Other recent ribbons include: Outstanding Large Quilt, a major award at Road to California (2019); as well as a 2nd place in the Animal Category; 1st place in the Wall Quilt Category in MQX New England (2019); Honorable Mention at AQS Grand Rapids (2018); Best Use of Color Award at the Lancaster Quilt Fest (2019); 3rd place Wall Category, Mid-Atlantic Quilt Festival (2018); 2nd place Wall Category, Pacific International Quilt Show (2018); 3rd place at TAG Art Gallery (2018), and Best of Show at the River City Quilters' Guild Show (2018).



**Sandra Mollon**  
*Featured Artist, 2019*

Several of Sandra's quilts are displayed in the book, "500 Traditional Quilts" by Lark Publications.

Sandra has been quilting for over 30 years and teaching for 15. Sandra Mollon was key in designing and creating the 2018 RCQG Opportunity Quilt. She was chosen as this year's Featured Artist due to her expertise and wide variety of quilting styles. We appreciate her willingness to share ideas, as well as her overall commitment to the guild.

### **SANDRA MOLLON LECTURE**

#### **"The Use of Textured Fabrics and Embellishment"**

Sunday, Sept. 29, 1:30-2:30 p.m. (McClellan Room, space available)

***Free lecture with your 3-day paid admission.***

This PowerPoint lecture details techniques Sandra uses in her traditional and art quilts to add interest and texture, including machine work, hand work, and adding mixed media onto fabric.

## OPPORTUNITY DRAWINGS

*Our Festival is partially funded by raffle ticket sales for the Opportunity Quilt and a session at the Empty Spools Seminar at Asilomar. The drawings will be held Sunday, 3:00 p.m. You do not need to be present to win.*

### **Opportunity Quilt – Yesterday’s, Today’s and Tomorrow’s Dreams**

This year’s Opportunity Quilt was awarded “Best Use of Color,” as well 2nd place for “Pieced Quilts, Large, Group 3+,” at the River City Quilters’ Guild Quilt Show in 2018. It was designed by Madhu Mathur of Jaipur, India. Guild members Laurel Anderson, Korey Chase, Nancy MacDonald, and Jacque Tucker selected the color palate. Mr. Chase arranged the color placement for the blocks creating a balance between the colors, prints and background fabrics. The blocks were pieced by many of our members and arranged by Laurel Anderson, Chris Shores-Hague, and Korey Chase. Long-arm quilter, Marie Nelson of Sacramento, used variegated thread colors to create an overall beautiful design on both sides. Pat Weissensee added the final touch with a flanged binding. See our website [www.quiltandfabricartfestival.com](http://www.quiltandfabricartfestival.com) for more information.



### Opportunity Raffle

— ENTER TO WIN —

## **EMPTY SPOOLS SEMINAR AT ASILOMAR**

Purchase tickets to win a session at Empty Spools Seminar at Asilomar for either 2020 or 2021. This is a wonderful chance to take instruction from national and internationally renown instructors at a beautiful venue along the California coast. Includes all meals and a space in a double occupancy room (however, the winner may pay the difference to upgrade to a single occupancy room).

**Raffle tickets are available at the RCQG  
Opportunity Quilt table in the front entrance area.**

*This is an \$1,800 value that can be yours for as little as \$1.*

## VENDORS

All vendors are located in the main display room.

### **A Couple of Old Broads**

[www.coupleofoldbroads.com](http://www.coupleofoldbroads.com)

### **Aloha Quilt Shop**

[www.alohaquiltshop.com](http://www.alohaquiltshop.com)

### **Always Unique Hand-Dyed Fabric**

[www.alwaysuniquefabric.com](http://www.alwaysuniquefabric.com)

### **Auntie Em's Quilts**

### **Barbara Wagner**

### **Beyond Interiors**

[www.beyondinteriors.com](http://www.beyondinteriors.com)

### **Candybanks Studio**

[candybanksstudio.wordpress.com](http://candybanksstudio.wordpress.com)

### **Cello Chocolate**

[www.cellochocolate.com](http://www.cellochocolate.com)

### **Cindy Carroll Quilts presents Studio 180 Design**

### **Cindy's Fabric Boutique**

[www.cindysfabricboutique.etsy.com](http://www.cindysfabricboutique.etsy.com)

### **Claudia Schwalm Photography and Folk Art**

### **Fabric Garden**

[www.fabricgardenquiltshop.com](http://www.fabricgardenquiltshop.com)

### **Finishing Touch 4 You**

[www.finishingtouch4you.com](http://www.finishingtouch4you.com)

### **Fino Artisan Chocolate**

[www.finochocolate.com](http://www.finochocolate.com)

### **Generation to Generation Heirlooms**

[www.generationheirlooms.com](http://www.generationheirlooms.com)

### **Global Marketplace**

[www.globalmarketplace.com](http://www.globalmarketplace.com)

### **Janet Spencer**

### **Jewels & Fiber**

[www.jewelsandfiber.com](http://www.jewelsandfiber.com)

## SPECIAL EXHIBITS

- Camellia City Rug Hookers Guild
- Rancho Cordova Arts
- Studio Art Quilt Association – Local Connection

### **Lady Bug Lace**

[www.ladybuglace.com](http://www.ladybuglace.com)

### **Lisa Smith**

### **Marsha Mason**

[www.marshamasonworks.com](http://www.marshamasonworks.com)

### **Maureen Schmidt Hand Dyed Fabrics**

### **Meissner Sewing and Vacuum Center**

[www.meissnersewing.com](http://www.meissnersewing.com)

### **Pegboard Highway**

### **Quilts by Cathy**

### **Quilter's Hands**

[www.quiltershands.com](http://www.quiltershands.com)

### **Real Time Pain Relief**

[www.alwayspainfree.com](http://www.alwayspainfree.com)

### **Sew-N-Tech**

[www.sew-n-tech.com](http://www.sew-n-tech.com)

### **Shelley Lencioni**

[www.iloverughooking.com](http://www.iloverughooking.com)

### **Stitchin' By the River**

[www.etsy.com/shop/stitchinbytheriver](http://www.etsy.com/shop/stitchinbytheriver)

### **Swift Stitches**

[www.swiftstitches.com](http://www.swiftstitches.com)

### **Tenaj Creations**

### **Tensisters Handicraft**

[www.tensisters.com](http://www.tensisters.com)

### **Unbuttons!**

[www.unbuttons.com](http://www.unbuttons.com)

### **Villa Rosa Designs**

[www.villarosadesigns.com](http://www.villarosadesigns.com)

### **Zombie Yarns**

[www.zombieyarns.com](http://www.zombieyarns.com)

## DEMONSTRATIONS

### Friday, September 27

- 11:00 a.m. Over the Edge Binding (Carmen Gedde)
- Noon What to do with a Layer Cake (Fabric Garden)
- 1:00 p.m. Easy Paper Piecing with Freezer Paper (Paulette Trafecanty)
- 2:00 p.m. Wing Clipper Tool for Flying Geese (Cindy Carroll, Studio 180)
- 3:00 p.m. Coloring for Embroidery (Vickie Carter)

### Saturday, September 28

- 11:00 a.m. Coloring for Embroidery (Vickie Carter)
- Noon What to do with a Layer Cake (Fabric Garden)
- 1:00 p.m. Easy Paper Piecing with Freezer Paper (Paulette Trafecanty)
- 2:00 p.m. Over the Edge Binding (Carmen Gedde)
- 3:00 p.m. Hot Cup Cosy (Candybanks Studio)

### Sunday, September 29

- 10:00 a.m. English Paper Piecing with Hexagons (Sandy Ross)
- 12:00 p.m. Rapid Fire Lemoyne Star Tool (Cindy Carroll, Studio 180)

## MONTHLY MEETINGS AND WORKSHOPS AT RCQG

*You are invited to join the guild or attend the meetings for a \$5 guest fee. Meetings are held the 3rd Tuesday of each month at 6:30 p.m. Workshops are generally held the day after our meetings and are open to non-members, based on space available. Pre-registration required.*

### 2019

- October: Dora Cary
- November: Sandra Mollon
- December: Holiday Party

### 2020

- January: Susy Nash
- February: Rami Kim
- March: Lynn Koolish
- April: Lisa Thorpe
- May: Fern Royce
- June: Martha Wolfe
- July: Community Service Night
- August: Mentor Night
- September: Trudy Cleveland
- September 25-27: Festival
- October: Material Girlfriends
- November: Julia McLeod & Sue Fox
- December: Holiday Party



Details are available at:  
[www.rivercityquilters.org](http://www.rivercityquilters.org)



## QUILT MAKER LIST

Bonnie Abramson: 80  
Barbara Allison: 7, 222, 282, 285, 286  
Britte Bany: 128, 290  
Micheyl Barnett: 89, 242  
Kari Bauer: 273, 293  
Linda Bergmann: 75  
Julie Berry: 316, 326  
Maria Billings: 121  
Leslie J Boak: 43  
Nadine Braunstein: 112, 130  
Donna Brennan: 66, 119, 161  
Cathy Brorby: 44, 74, 150, 158, 219  
Kim Brownell: 88, 142, 151, 157, 339  
Roberta Burke: 11, 170, 308  
Nancy Calhoun: 204  
Cindy Carroll: 84, 211, 301  
Nancy Causey: 81, 171, 178, 304  
Janice Chally: 13  
Korey J Chase: 78, 193, 203  
Kate Christiansen: 25, 39, 127, 183, 228, 300, 307  
Deborah Ciarla: 27, 49, 59, 132, 147, 154, 299  
Jackie Clauson: 160, 180, 244  
Lynn Cordeiro: 45  
Crafty Quilters: 5  
Frances L A Dack: 140, 144, 153, 162, 238  
Doreen Diehl: 206, 209, 212, 214, 216  
Marylee Drake: 123, 314  
Nanette Eby: 58, 283, 284  
Marion Emerson: 10, 64, 295  
Eskaton Adult Day Health Center (Carmichael): 341  
Chris Everman: 34  
Tamera J. Failla: 109, 114  
Mary Fish: 33, 143, 164  
Vicky J Fong: 37, 190, 311, 338  
Winifred Fung: 90  
Nancy Gangler: 28, 30, 184, 201, 230  
Pat Gillings: 319  
Penny S. Hanscom: 148, 159  
Shireen Hattan: 51  
Jane Haworth: 56, 97, 322  
Heart of California Quilters: 2  
Lori Hemmingsen-Souza: 310  
Connie Horne: 115  
Keitha Hunter: 24  
Emily Jackson: 208, 217  
Verna Karnes: 104  
Jackie Kelly: 281, 298  
Sondra Lathe: 67, 69, 163, 165, 207, 213, 237, 343  
Esther Latino: 47, 50  
Rita Lauchli: 340  
Linda Lawrence: 26, 38, 126, 131, 155, 182, 195, 303  
Patti Lease: 133  
Ginny Lee: 329, 332  
Anita Lerch: 229, 288  
Tracey List: 31, 223, 277  
Jenny K. Lyon: 189, 226  
Danya MacDonald: 8  
Nancy Elliott MacDonald: 29, 234  
Jane Magaw: 306  
Carole Mah: 241, 278  
Jackie Manley: 325  
Beverly Martinez: 42, 169  
Elaine Mason: 289, 313  
Linda McAuliffe: 138  
Phyllis Leavitt McCalla: 198  
Pat McCandless: 134  
Midtown Night Quilters: 168  
Diane G. Miller: 18  
Kathy Mitchell: 1, 32, 83, 227

**Sandra Mollon (Featured Artist):**

246, 247, 248, 249, 250, 251, 252,  
253, 254, 255, 256, 257, 258, 259,  
260, 261, 262, 263, 264, 265, 266,  
267, 268, 269

Teri Moore: 15

Sharon Moos: 291, 337

Trish Morris-Plise: 41, 120, 197, 324

Mary Jane Motter: 149, 196

Mountain Art Quilters: 124

Diana Muenzler: 54, 61, 86, 98, 111,  
176, 191, 274

Marie Nelson: 9, 77, 156, 194, 200, 205

Nellie Nelson: 45

Linda Newens: 101

Joan Noell: 36

Kitty Oliver: 231

Gail Palmer: 82, 108, 113, 141

Michelle Peerson: 317

Brenda Perry: 87

Jill Petrucci: 103, 110

Lori Phillips: 14

Carole Pirruccello: 79, 342

Karin Polli: 137, 333

Tiffany Poulson: 71, 305

Marsha Poust: 272

RCQG Members: 220, 344, 345

RCQG Outreach Committee: 341

Jan Reed: 320, 327, 328, 331

Chrissie Reising: 16, 70, 139, 188

Carol Riggert: 136

Ellen M Roberts: 334

Peggy Robles: 3, 60, 68, 181, 187,  
271, 279

Carole Rossi: 100, 318

Annette Salazar: 57, 63, 309

Lin Schiffner: 91, 92, 93, 94

Ruth Schindler: 186

Denise Schmidt: 96, 122, 146

Judy Scollay: 35, 76, 106, 280

Patty Shaw: 221

Chris Shores-Hague: 166, 177

Kim Sikes: 46, 55, 240

Pins and Needles Art Quilters: 235

Linda Siska: 321, 323

Carol L Smith: 17, 65

Julia Smith: 22, 73, 215, 218

Jan Soules: 40, 48, 53, 107, 118, 210,  
302

Susan Spicer: 243

Diane Steele: 199, 202

Cheryl Stern: 245

Elizabeth Stewart: 296

Patty Thompson: 233

Paulette Trafecanty: 21, 129, 335

Lynn Tubbe: 99, 117, 315, 330

Kristy Updegraff: 336

Joy Valenton: 62, 239

Janet A Van Wert: 270, 292, 312

Kathie Vaughn: 225

Linda Waddle: 95, 116, 125

Julie Wall: 4

Jaime Watson: 232

Pat Weissensee: 276, 287, 297

Charlotte Westlake: 20

Mary Wilkinson: 175, 192

Kellie Willey: 52, 85, 72, 145, 152

Lori Wisheropp: 23, 236

Peggie Wormington: 6, 135, 167,  
173, 174, 179, 185, 224

Chere Yamasaki: 19, 102

Sally Anne Young: 105, 172

Carol Zelinski: 12, 275, 294

## JUDGING INFORMATION

Quilt entries are evaluated by experienced, professional judges using the elimination, pathway process. Awards are given at the sole discretion of the judges. In addition to traditional ribbon awards, the following may include monetary recognition:

- Best of Show - Traditional Quilt
- Best of Show - Art Quilt
- Best Use of Color
- Best Long-Arm Machine Quilting
- Best Domestic Machine Quilting
- Best Hand Quilting
- Best Interpretation of Quilt Festival Theme
- Judges' Choice (one per judge)
- Best of Category Awards (selected from the 1st place winners in that category)

### Viewer's Choice Award

Please submit your ballot near the entrance. Voting ends on Saturday at 4 p.m. The winners are announced on Sunday.

- Harriet Merriam Award  
*Viewer's favorite quilt/item*
- Lil Hutzler Award  
*Viewers' most "fun" quilt/item*

### FESTIVAL JUDGES

Julie Curry  
Jennifer Landau  
Jody Ohrt  
Diane Perin

See their biographies at  
[www.rivercityquilters.org](http://www.rivercityquilters.org)

## DISPLAY CODES

### Categories/Type of Quilt

*The following categories are one and two persons unless otherwise noted.*

1. Quilt Festival Challenge
2. Pieced
3. Appliqué
4. Miniature: 1 person only
5. Art-Abstract: 1 person only
6. Art-Pictorial: 1 person only
7. Wearable: 1 person only
8. Modern
9. Kit Quilt/Item
10. All Other Techniques
11. Group Quilt: 3 or more persons

### Group Codes

- AQ = Arty Q's  
FA = Featured Artist  
FQB = Foothill Quilters Guild BOM  
GSQ = Granny Smith Quilters  
MOQ = Mission Oaks Quilting Club  
MAQ = Mountain Art Quilters  
MBL = Mrs. Bills Lakers  
PNW = Pins and Needles Art Quilters  
RFC = RCQG Festival Challenge  
SMQG = Sacramento Modern Quilt Guild and Friends  
SALC = SAQA Local Connections

**One-Person:** Any quilt or item made entirely by the entrant.

**Two-Person Quilt:** Any quilt or item made by two people (pieced by one person and quilted or bound by another person).

**Group Quilt:** Any quilt made by three or more persons, including quilting or binding.

## QUILT LIST

1	Kathy Mitchell, Quilter: David Hurd Diagonal Mess	Exhibited-2 78x82
2	Heart of Calif. Quilters, Quilter: Delpha Weatherson Cleopatra's Fans	Judged-11 82x82
3	Peggy Robles Ecco Cake Mix	Judged-2 70x70
4	Julie Wall, Quilter: Debbie Olivera Julie's Gem	Judged-2 79x80
5	Crafty Quilters, Quilter: Kristy Updegraff North Star	Judged-11 80x80
6	Peggie Wormington, Quilter: Pamela Dransfeldt Uncommon Bride	Exhibited-10 78x78
7	Barbara Allison, Quilter: Carol Dickson Blue Four Corners	Judged-2 89x89
8	Danya MacDonald, Quilter: Shireen Hattan A Long Walk in the Garden	Judged-9 102x110
9	Marie Nelson The Maharani's Geese	Judged-2 92x98
10	Marion Emerson A Hard Road to Walk	Judged-2 90x90
11	Roberta Burke, Quilter: Gina Boyd Folk Hearts	Judged-2 107x73
12	Carol Zelinski A Nickel's Worth of Stars	Exhibited-2 90x90
13	Janice Chally Sunshine, Hope and Happiness	Exhibited-2 59x72, GSQ

*Join the Guild!*

Monthly General Meetings • Workshops  
*Check out the 2020 schedule on our website.*

Small Neighborhood Circles and Groups • Quilt Retreats  
Community Service Projects • Block of the Month • Library  
Mentoring • Secret Pals • Sew and Show • Quilt Festival

**River City Quilters' Guild**  
[www.rivercityquilters.org](http://www.rivercityquilters.org)

<b>14</b>	Lori Phillips Christmas Tree Table Runner	Exhibited-2 20x62, GSQ
<b>15</b>	Teri Moore, Quilter: Debra Ludden Granny Smith Quilt Challenge (2019)	Judged-2 31x31, GSQ
<b>16</b>	Chrissie Reiswig For the Love of Music	Judged-2 30x50, GSQ
<b>17</b>	Carol L Smith Black and White Challenge - Log Cabin	Judged-2 61x73, GSQ
<b>18</b>	Diane G. Miller, Quilter: Inga Waegell Love Birds by Kathy Doughty	Judged-10 84x84
<b>19</b>	Chere Yamasaki, Quilter: Lin Squires Tropical Sashiko Sampler	Judged-10 72x72
<b>20</b>	Charlotte Westlake Munch a Bunch	Judged-3 45x52
<b>21</b>	Paulette Trafecanty, Quilter: Deborah Dolce Asterisks	Exhibited-2 43x62
<b>22</b>	Julia Smith Iowa in Bloom	Exhibited-2 45x63
<b>23</b>	Lori Wisheropp, Quilter: Marie Nelson Ella's Pink Petals	Judged-2 72x90
<b>24</b>	Keitha Hunter, Quilter: Sandy Hulquist Kaffe-tastrophe	Exhibited-2 48x48
<b>25</b>	Kate Christiansen, Quilter: Quilts by Cathy Christmas in Florida	Exhibited-2 48x42
<b>26</b>	Linda Lawrence, Quilter: Lin Squires Amadeus	Judged-2 71x71
<b>27</b>	Deborah Ciarla, Quilter: Nancy Calhoun Pineapples Galore	Exhibited-9 49x57
<b>28</b>	Nancy Gangler Oh, My Stars	Judged-2 50x60
<b>29</b>	Nancy Elliott MacDonald Round the Twinkles	Judged-2 72x72
<b>30</b>	Nancy Gangler Churned	Judged-2 50x65
<b>31</b>	Tracey List, Quilter: Bruce Cornelius Chaos	Judged-2 50x66
<b>32</b>	Kathy Mitchell I Got the Blues, Don't Know Why	Exhibited-2 72x86
<b>33</b>	Mary Fish Autumn Leaves	Judged-2 51x51

<b>34</b>	Chris Everman Tablecloth Tabby Cats	Judged-10 51x58
<b>35</b>	Judy Scollay Ombre Star	Exhibited-2 72x72
<b>36</b>	Joan Noell, Quilter: Lin Squires Redwork Romance	Exhibited-2 51x58
<b>37</b>	Vicky J Fong Flower of Life	Judged-3 45x44
<b>38</b>	Linda Lawrence, Quilter: Lin Squires Vienna Nights	Exhibited-2 72x89
<b>39</b>	Kate Christiansen, Quilter: Quilts by Cathy Blooming Hibiscus	Exhibited-2 52x52
<b>40</b>	Jan Soules Loving Amsterdam	Judged-6 52x37
<b>41</b>	Trish Morris-Plise, Quilter: Sandra Bruce Portrait Noir	Judged-2 80x80
<b>42</b>	Beverly Martinez Peacock Blues	Exhibited-9 38x58
<b>43</b>	Leslie J Boak Pete of Wilbur Manor	Judged-3 43x64
<b>44</b>	Cathy Brorby, Quilter: Marie Nelson Wild and Crazy Flower Garden	Judged-3 72x73
<b>45</b>	Nellie Nelson/Lynn Cordeiro, Quilter: Lynn Cordeiro Family Tradition	Exhibited-2 44x52
<b>46</b>	Kim Sikes Garden Pink	Judged-3 40x18
<b>47</b>	Esther Latino Rose Garden	Judged-3 75x87
<b>48</b>	Jan Soules, Quilter: Shelley Nealon Diamonds are Forever	Judged-2 72x73
<b>49</b>	Deborah Ciarla, Quilter: Nancy Calhoun Autumn Love	Judged-9 74x84
<b>50</b>	Esther Latino Carpenter's Wheel	Judged-2 78x91
<b>51</b>	Shireen Hattan Dragonflies Snails and Geese	Judged-2 68x87
<b>52</b>	Kellie Willey Give Thanks	Exhibited-2 45x45
<b>53</b>	Jan Soules The Bedroom	Exhibited-6 20x20
<b>54</b>	Diana Muenzler Joyful in Pink	Judged-9 24x20

<b>55</b>	Kim Sikes In Full Bloom	Judged-6 20x20
<b>56</b>	Jane Haworth ARTHUR	Exhibited-6 23x30
<b>57</b>	Annette Salazar Night Lights	Judged-4 21x21
<b>58</b>	Nanette Eby Vineyard Tranquility	Exhibited-6 22x36
<b>59</b>	Deborah Ciarla 101 Happy Trees AND a Cabin!	Judged-4 20x20
<b>60</b>	Peggy Robles Ghost Points	Exhibited-2 26x31
<b>61</b>	Diana Muenzler Triangles	Judged-4 8x11
<b>62</b>	Joy Valenton Shimmering Holidays	Exhibited-6 8x12
<b>63</b>	Annette Salazar Hummingbird Baths	Judged-4 9x9
<b>64</b>	Marion Emerson Lemons and Artichoke Flowers	Judged-5 15x22
<b>65</b>	Carol L Smith He is Risen	Exhibited-3 15x34
<b>66</b>	Donna Brennan One Step Leads to the Next	Judged-4 11x16
<b>67</b>	Sondra Lathe Autumn Circles	Judged-5 11x26
<b>68</b>	Peggy Robles Raining Cats and Dogs	Exhibited-6 12x13
<b>69</b>	Sondra Lathe Watercolor Improv	Exhibited-5 17x35
<b>70</b>	Chrissie Reiswig Hollyhock	Judged-1 22x50, RFC
<b>71</b>	Tiffany Poulson Joseph's Dream Coat Swatch	Judged-4 14x18
<b>72</b>	Kellie Willey Believe	Judged-9 18x25
<b>73</b>	Julia Smith Gracie	Exhibited-3 16x20
<b>74</b>	Cathy Brorby Marsh Sunset	Exhibited-6 16x26
<b>75</b>	Linda Bergmann April and Taj	Judged-6 20x24

<b>76</b>	Judy Scollay Log Cabin with a Twist	Exhibited-2 24x24
<b>77</b>	Marie Nelson Bargello	Judged-1 86x96, RFC
<b>78</b>	Korey J Chase Unicorn Bedrunner for Samantha	Judged-1 86x30, RFC
<b>79</b>	Carole Pirruccello House of Whimsy	Judged-10 26x35, RFC
<b>80</b>	Bonnie Abramson Interlocking Friendships	Judged-1 26x26, RFC
<b>81</b>	Nancy Causey Happy Hawaiian Papaya	Judged-1 24x15, RFC
<b>82</b>	Gail Palmer Fabric Fun	Exhibited-1 26x18, RFC
<b>83</b>	Kathy Mitchell Lulu in Her Flower Garden	Exhibited-1 18x18, RFC
<b>84</b>	Cindy Carroll, Quilter: Nancy Calhoun Mini Freelancer	Exhibited-1 18x18, RFC
<b>85</b>	Kellie Willey Mr. Chester	Judged-1 17x16, RFC
<b>86</b>	Diana Muenzler Abstract Topographical California Map	Exhibited-1 18x28, RFC
<b>87</b>	Brenda Perry My Wildest Dream	Judged-1 55x55, RFC
<b>88</b>	Kim Brownell The Time is Now	Judged-1 21x21, RFC
<b>89</b>	Micheyl Barnett A Passion for Purple	Judged-1 21x28, RFC
<b>90</b>	Winifred Fung Foundation Happening	Judged-1 37x37, RFC
<b>91</b>	Lin Schiffner Winter Moon	Exhibited-6 18x38, SALC
<b>92</b>	Lin Schiffner Spring Moon	Exhibited-6 18x38, SALC
<b>93</b>	Lin Schiffner Summer Moon	Exhibited-6 18x38, SALC
<b>94</b>	Lin Schiffner Autumn Moon	Exhibited-6 18x38, SALC
<b>95</b>	Linda Waddle Door #2	Exhibited-6 27x39, SALC
<b>96</b>	Denise Schmidt Dendroid	Judged-5 24x28, SALC



<b>97</b>	Jane Haworth B for Bovine	Exhibited-6 27x24, SALC
<b>98</b>	Diana Muenzler Paint Chips	Judged-5 32x48, SALC
<b>99</b>	Lynn Tubbe Piece-ful Paris	Exhibited-6 50x43, SALC
<b>100</b>	Carole Rossi Unaffordable Housing	Exhibited-5 33x27, SALC
<b>101</b>	Linda Newens, Quilter: Debra Coleman Snippets of Joy	Judged-2 80x90
<b>102</b>	Chere Yamasaki, Quilter: Lin Squires Happy Trails	Judged-3 71x71
<b>103</b>	Jill Petrucci, Quilter: Rhea Weins A Collection of Tiles	Judged-2 73x90
<b>104</b>	Vera Karnes Vera's Quilt	Exhibited-3 76x90
<b>105</b>	Sally Anne Young Pathway to the Stars	Exhibited-2 90x102
<b>106</b>	Judy Scollay Fancy Forest	Exhibited-2 35x35
<b>107</b>	Jan Soules Purple Coneflowers	Judged-6 35x52
<b>108</b>	Gail Palmer Silk Sari Ribbon Scarf	Judged-7
<b>109</b>	Tamera J. Failla Injigokiko (Indigo Chrysanthemum)	Judged-7
<b>110</b>	Jill Petrucci From Thriftstore Quilt to Cozy Jacket	Judged-7
<b>111</b>	Diana Muenzler Terrific Tabard	Judged-7
<b>112</b>	Nadine Braunstein My Guild Retreat Tote	Judged-7
<b>113</b>	Gail Palmer Multi-Tasker Tote	Judged-7
<b>114</b>	Tamera J. Failla Non-Sensical Sepia	Judged-7
<b>115</b>	Connie Horne Prince Purple Rain Jacket and Purse	Judged-7
<b>116</b>	Linda Waddle Neptune's Garden	Exhibited-6 41x26, SALC
<b>117</b>	Lynn Tubbe Hope	Exhibited-6 43x36, SALC

<b>118</b>	Jan Soules Ponte Vecchio	Judged-10 36x42, SALC
<b>119</b>	Donna Brennan Red with Blue/Blue with Red	Exhibited-5 18x36, SALC
<b>120</b>	Trish Morris-Plise Red	Exhibited-3 20x37, SALC
<b>121</b>	Maria Billings Bride	Judged-6 60x90, SALC
<b>122</b>	Denise Schmidt Fog Bank	Judged-6 20x16, SALC
<b>123</b>	Marylee Drake Simple Circles	Exhibited-2 16x43, SALC
<b>124</b>	Mountain Art Quilters, Quilter: Marylee Drake Sunflowers	Exhibited-6 33x25, SALC
<b>125</b>	Linda Waddle April Showers	Exhibited-5 33x32, SALC
<b>126</b>	Linda Lawrence, Quilter: Ingrid Cattaneo How's the View up There?	Exhibited-3 40x55
<b>127</b>	Kate Christiansen, Quilter: Quilts by Cathy Time for Tykes	Exhibited-2 40x48
<b>128</b>	Britte Bany Night Pumpkins	Judged-2 36x36
<b>129</b>	Paulette Trafecanty Sweet Gingham Baby Quilt	Exhibited-2 37x53
<b>130</b>	Nadine Braunstein L'Chaim Leo	Judged-2 36x36
<b>131</b>	Linda Lawrence Pansies	Judged-3 38x26
<b>132</b>	Deborah Ciarla, Quilter: Nancy Calhoun Flying Home	Judged-2 38x46
<b>133</b>	Patti Lease My First Paper Piecing	Exhibited-2 30x30, FQB
<b>134</b>	Pat McCandless Arizona Sunrise	Exhibited-2 26x26, FQB
<b>135</b>	Peggie Wormington, Quilter: Teri Sartain Big Bang Theory	Exhibited-2 45x45, FQB
<b>136</b>	Carol Riggert, Quilter: Beth Handy Out on a Limb	Exhibited-2 57x64, FQB
<b>137</b>	Karin Polli Mom's Flower Garden	Exhibited-2 36x36, FQB
<b>138</b>	Linda McAuliffe Planned Chaos vs. Quiet Riot	Exhibited-2 31x30, FQB

<b>139</b>	Chrissie Reiswig My 1st Quilt of Firsts	Judged-9 10x12
<b>140</b>	Frances L A Dack Where Have all the Apples Gone?	Judged-6 12x12
<b>141</b>	Gail Palmer Little Crisscross	Judged-4 15x15
<b>142</b>	Kim Brownell Rainforest Tryptich	Exhibited-3 31x20
<b>143</b>	Mary Fish Furry Friends Forever	Judged-3 31x22
<b>144</b>	Frances L A Dack Pretty Bird	Exhibited-6 11x9
<b>145</b>	Kellie Willey Little English Garden	Judged-4 12x12
<b>146</b>	Denise Schmidt Circle Series #6	Judged-4 13x16
<b>147</b>	Deborah Ciarla Scrappy Mini	Judged-4 17x17
<b>148</b>	Penny S. Hanscom Land of the Free	Judged-6 30x30
<b>149</b>	Mary Jane Motter, Quilter: Deborah Dolce Sledrunner	Exhibited-2 30x62
<b>150</b>	Cathy Brorby Mandala	Judged-3 17x17
<b>151</b>	Kim Brownell Recycled Ocean	Judged-6 24x32
<b>152</b>	Kellie Willey Annabelle	Judged-10 15x19
<b>153</b>	Frances L A Dack Red Cell Division	Exhibited-5 18x19
<b>154</b>	Deborah Ciarla Technicolor Dream	Exhibited-5 18x21
<b>155</b>	Linda Lawrence Tulips and Butterflies	Exhibited-3 24x29
<b>156</b>	Marie Nelson Mr. Dembasa	Judged-6 22x28
<b>157</b>	Kim Brownell Oriental Garden Vest	Exhibited-7 21x30
<b>158</b>	Cathy Brorby It's all Square	Exhibited-10 21x21
<b>159</b>	Penny S. Hanscom Read the Fine Print	Judged-6 20x30

<b>160</b>	Jackie Clauson Welcome to the North Pole	Exhibited-3 21x26
<b>161</b>	Donna Brennan Britex	Exhibited-6 27x26
<b>162</b>	Frances L A Dack Gecko's Kitchen	Exhibited-5 25x33
<b>163</b>	Sondra Lathe Bella	Judged-6 20x22
<b>164</b>	Mary Fish Waterfall	Judged-9 22x32
<b>165</b>	Sondra Lathe Images	Exhibited-2 30x40
<b>166</b>	Chris Shores-Hague I Shall Pass this Way	Exhibited-4 20x24
<b>167</b>	Peggie Wormington Homage to Miss Betty L	Judged-4 29x29
<b>168</b>	Midtown Night Quilters, Quilter: Loretta Lowe Rainbow over Midtown	Judged-11 41x49
<b>169</b>	Beverly Martinez Ellie the Elephant	Exhibited-3 42x33
<b>170</b>	Roberta Burke, Quilter: Gina Boyd Seeds of Life	Judged-2 68x68
<b>171</b>	Nancy Causey, Quilter: Marie Nelson Colorado Argyle	Judged-2 67x80
<b>172</b>	Sally Anne Young Bears Paw	Exhibited-2 76x93
<b>173</b>	Peggie Wormington, Quilter: Maggi Honeyman Sunflower Gatherings	Exhibited-10 66x66
<b>174</b>	Peggie Wormington, Quilter: Maggi Honeyman Something Old Something New	Judged-10 69x76
<b>175</b>	Mary Wilkinson Christmas Morning Delight	Judged-2 38x38
<b>176</b>	Diana Muenzler Tranquility at Sea	Judged-2 44x44
<b>177</b>	Chris Shores-Hague, Quilter: Cathy Evans The Family Reunion	Judged-2 66x66
<b>178</b>	Nancy Causey Nolan's Jelly Fish	Exhibited-10 60x60
<b>179</b>	Peggie Wormington, Quilter: Beth Handy Stars Among Stars	Judged-2 65x72
<b>180</b>	Jackie Clauson, Quilter: Carole Mah Quilt Camp	Judged-9 60x65

<b>181</b>	Peggy Robles BLOOM	Judged-3 60x70
<b>182</b>	Linda Lawrence, Quilter: Lin Squires Garden Magic	Judged-3 60x72
<b>183</b>	Kate Christiansen, Quilter: Quilts by Cathy Flowers for a Picnic	Exhibited-2 61x61
<b>184</b>	Nancy Gangler Spool Sampler	Judged-9 61x72
<b>185</b>	Peggie Wormington, Quilter: Precision Quiltworks Gardens of My Heart	Judged-3 61x76
<b>186</b>	Ruth Schindler, Quilter: Deborah Dolce Magic Mountains	Exhibited-2 97x99
<b>187</b>	Peggy Robles Witches Hats	Judged-3 96x112
<b>188</b>	Chrissie Reiswig Glory, Glory	Judged-9 82x89
<b>189</b>	Jenny K. Lyon Moonlit Garden	Exhibited-10 38x46
<b>190</b>	Vicky J Fong Block Party	Judged-2 38x52
<b>191</b>	Diana Muenzler Birds are so Cute!	Exhibited-2 36x33
<b>192</b>	Mary Wilkinson Flight	Judged-9 37x57
<b>193</b>	Korey J Chase Bearpaws for my Bed	Judged-9 63x75
<b>194</b>	Marie Nelson Off the Reservation	Judged-2 98x98
<b>195</b>	Linda Lawrence, Quilter: Lin Squires Fall Harvest	Exhibited-3 62x77
<b>196</b>	Mary Jane Motter, Quilter: Deborah Dolce Winter Wonderland	Judged-9 62x69
<b>197</b>	Trish Morris-Plise Awaphui (White Ginger)	Judged-3 96x96
<b>198</b>	Phyllis Leavitt McCalla, Quilter: Laura Jansen Jardin de Fastasic	Judged-3 62x64
<b>199</b>	Diane Steele Inspired by Nordic Knitwear	Exhibited-2 61x79, SMQG
<b>200</b>	Marie Nelson Zu Zu - Plan D	Judged-8 96x96, SMQG
<b>201</b>	Nancy Gangler Lazy Goose	Judged-8 60x75

<b>202</b>	Diane Steele, Quilter: Marie Nelson Tutti Fruity	Judged-2 79x98, SMQG
<b>203</b>	Korey J Chase Modern Dreams of Wild Dragonflies	Judged-8 93x104, SMQG
<b>204</b>	Nancy Calhoun Quilt as Desired	Exhibited-8 63x63
<b>205</b>	Marie Nelson Bagatelle	Judged-8 60x60, SMQG
<b>206</b>	Doreen Diehl Flower Stalls	Exhibited-8 58x58, SMQG
<b>207</b>	Sondra Lathe, Quilter: Gina Boyd Denim Stars	Judged-8 60x64, SMQG
<b>208</b>	Emily Jackson Sunset Interwoven Quilt	Judged-8 56x70, SMQG
<b>209</b>	Doreen Diehl Wedgie	Exhibited-8 57x57, SMQG
<b>210</b>	Jan Soules Tang	Judged-8 56x55
<b>211</b>	Cindy Carroll, Quilter: Nancy Calhoun Fiesta	Judged-8 55x70
<b>212</b>	Doreen Diehl Improv Log Cabin AKA: "Bruised"	Exhibited-8 42x53, SMQG
<b>213</b>	Sondra Lathe Scrappy Improv	Judged-8 16x42, SMQG
<b>214</b>	Doreen Diehl Rock the Block	Exhibited-8 54x70, SMQG
<b>215</b>	Julia Smith Parallel Paths	Exhibited-8 47x52, SMQG
<b>216</b>	Doreen Diehl If the Hat Fits	Exhibited-8 42x52, SMQG
<b>217</b>	Emily Jackson Miniature Mariners Compass Quilt	Judged-4 16x16, SMQG
<b>218</b>	Julia Smith Sky High	Exhibited-8 19x17, SMQG
<b>219</b>	Cathy Brorby Paper Cuts	Judged-8 41x37
<b>220</b>	RCQG Members (1990), Quilter: Michele Erl-Simes Double X	Exhibited-2 62x62
<b>221</b>	Patty Shaw, Quilter: Margaret Durkin Long Time Gone by Jen Kingwell	Exhibited-2 66x66
<b>222</b>	Barbara Allison, Quilter: Carol Dickson Asian Ladies	Exhibited-2 65x80

<b>223</b>	Tracey List Memories of Japan	Exhibited-2 40x55
<b>224</b>	Peggie Wormington, Quilter: Precision Quiltworks Good and Plenty	Judged-2 65x65
<b>225</b>	Kathie Vaughn, Quilter: Beth Lonquist Spring Fling	Exhibited-9 64x80
<b>226</b>	Jenny K. Lyon Prairie Afternoon	Exhibited-10 52x34
<b>227</b>	Kathy Mitchell Las Cruces de Mexico	Exhibited-2 64x75
<b>228</b>	Kate Christiansen, Quilter: Quilts by Cathy Pink and Green and Checks all Over	Exhibited-2 64x71
<b>229</b>	Anita Lerch Batik Pinwheels	Exhibited-2 45x45
<b>230</b>	Nancy Gangler Nesting Stars	Judged-9 64x64
<b>231</b>	Kitty Oliver HYGGE!	Judged-8 70x80, MBL
<b>232</b>	Jaime Watson Lakers Challenge (2019)	Exhibited-2 42x42, MBL
<b>233</b>	Patty Thompson Orange Crush	Exhibited-2 36x36, MBL
<b>234</b>	Nancy Elliott MacDonald Big Orange Diamonds	Judged-8 53x57, MBL
<b>235</b>	Pins & Needles Art Quilters, Quilter: Marie Nelson Round Robin Improv	Judged-11 35x38, PNW
<b>236</b>	Lori Wisheropp Watercolor	Exhibited-5 12x12, PNW
<b>237</b>	Sondra Lathe Rippels	Exhibited-5 12x12, PNW
<b>238</b>	Frances L A Dack Splat!	Judged-5 12x12, PNW
<b>239</b>	Joy Valenton Spherical Bubbles	Judged-5 12x12, PNW
<b>240</b>	Kim Sikes Inside a Watercolor	Judged-5 12x12, PNW
<b>241</b>	Carole Mah Watercolor Challenge	Exhibited-5 12x12, PNW
<b>242</b>	Micheyl Barnett Berry Bliss	Judged-8 12x12, PNW
<b>243</b>	Susan Spicer Pins and Needles Challenge - Watercolor	Exhibited-5 12x12, PNW

<b>244</b>	Jackie Clauson P and N Watercolor Challenge	Exhibited-5 12x12, PNW
<b>245</b>	Cheryl Stern No Title	Judged-5 12x12, PNW
<b>246</b>	Sandra Mollon, <i>Featured Artist</i> North Rim, Grand Canyon (2018)	Exhibited-6 52x28, FA
<b>247</b>	Sandra Mollon, <i>Featured Artist</i> Sisters / Best Friends (2018)	Judged-3 35x23, FA
<b>248</b>	Sandra Mollon, <i>Featured Artist</i> Reflections of Liberty Station (2016)	Exhibited-6 28x38, FA
<b>249</b>	Sandra Mollon, <i>Featured Artist</i> The Elephant in the Room (2019)	Judged-3 47x35, FA
<b>250</b>	Sandra Mollon, <i>Featured Artist</i> The Mute Swan	Judged-6 51x36, FA
<b>251</b>	Sandra Mollon, <i>Featured Artist</i> Baker Beach (2018)	Judged-6 53x38, FA
<b>252</b>	Sandra Mollon, <i>Featured Artist</i> Charlie	Exhibited-6 7x8, FA
<b>253</b>	Sandra Mollon, <i>Featured Artist</i> Felix	Exhibited-6 13x12, FA
<b>254</b>	Sandra Mollon, <i>Featured Artist</i> Lily of the Field (2014)	Exhibited-6 17x37, FA
<b>255</b>	Sandra Mollon, <i>Featured Artist</i> Make a leap for it	Exhibited-6 24x17, FA
<b>256</b>	Sandra Mollon, <i>Featured Artist</i> Le Printemps en Tisser	Exhibited-6 19x42, FA
<b>257</b>	Sandra Mollon, <i>Featured Artist</i> Lake of Dreams (2014)	Exhibited-6 17x9, FA
<b>258</b>	Sandra Mollon, <i>Featured Artist</i> Penelope Jane	Exhibited-6 16x20, FA
<b>259</b>	Sandra Mollon, <i>Featured Artist</i> Great Blue Heron	Exhibited-6 20x27, FA
<b>260</b>	Sandra Mollon, <i>Featured Artist</i> Liz, from a Selfie	Exhibited-6 24x24, FA
<b>261</b>	Sandra Mollon, <i>Featured Artist</i> Flourish	Exhibited-6 25x33, FA
<b>262</b>	Sandra Mollon, <i>Featured Artist</i> La Vida Loca Daylily (2019)	Exhibited-6 46x35, FA
<b>263</b>	Sandra Mollon, <i>Featured Artist</i> Reflections on Water	Exhibited-6 31x42, FA
<b>264</b>	Sandra Mollon, <i>Featured Artist</i> , Quilter: Kris Spray My Antique Toys (2015)	Exhibited-3 69x82, FA



<b>265</b>	Sandra Mollon, <i>Featured Artist</i> Sailing to Baltimore (2013)	Exhibited-3 59x59, FA
<b>266</b>	Sandra Mollon, <i>Featured Artist</i> Quilter: Creative Quilts of Galt Garden of Unity (2010)	Exhibited-3 79x79, FA
<b>267</b>	Sandra Mollon, <i>Featured Artist</i> Quilter: Creative Quilts of Galt Baltimore Album Medallion (2009)	Exhibited-3 92x92, FA
<b>268</b>	Sandra Mollon, <i>Featured Artist</i> Memories of Maryland (1998)	Exhibited-3 82x82, FA
<b>269</b>	Sandra Mollon, <i>Featured Artist</i> Frederick County Album (1994)	Exhibited-3 82x82, FA
<b>270</b>	Janet A Van Wert, Quilter: Beth Lonquist Mr. Pea Quack	Exhibited-6 31x21, AQ
<b>271</b>	Peggy Robles Butter-Phant	Judged-6 9x12, AQ
<b>272</b>	Marsha Poust Donkeysaurus	Exhibited-6 13x13, AQ
<b>273</b>	Kari Bauer Desert Fox Tortoise	Exhibited-6 24x18, AQ
<b>274</b>	Diana Muenzler What Color Am I?	Judged-10 18x12, AQ
<b>275</b>	Carol Zelinski Octo - Anemone	Exhibited-6 12x16, AQ
<b>276</b>	Pat Weissensee Flamooster / Roomingo	Judged-6 29x34, AQ
<b>277</b>	Tracey List, Quilter: Quilting by David Liberty Meets Tropical	Exhibited-2 57x72
<b>278</b>	Carole Mah Sweet Rose	Judged-9 57x69
<b>279</b>	Peggy Robles Aidan	Judged-6 36x28
<b>280</b>	Judy Scollay Bat Moon Rising	Exhibited-2 35x52
<b>281</b>	Jackie Kelly Bob's Big Foot	Exhibited-2 57x67
<b>282</b>	Barbara Allison The Koi Pond	Judged-2 43x56
<b>283</b>	Nanette Eby Winter	Exhibited-6 17x20
<b>284</b>	Nanette Eby Spring	Judged-6 17x20

<b>285</b>	Barbara Allison Scraps From the Pizza Box I	Exhibited-2 23x22
<b>286</b>	Barbara Allison Scraps From the Pizza Box II	Exhibited-2 39x45
<b>287</b>	Pat Weissensee Half and Half	Exhibited-9 55x71
<b>288</b>	Anita Lerch Morning Glories	Exhibited-2 37x48
<b>289</b>	Elaine Mason Stripes	Exhibited-2 42x51
<b>290</b>	Britte Bany Double Bubble Trouble	Exhibited-2 55x62
<b>291</b>	Sharon Moos Drunkards Path Bag	Exhibited-7 MOQ
<b>292</b>	Janet A Van Wert, Quilter: Beth Lonquist Curves, Beautiful Curves via Nancy MacDonald	Exhibited-2 42x46, MOQ
<b>293</b>	Kari Bauer Beckoning Cat	Exhibited-2 45x45, MOQ
<b>294</b>	Carol Zelinski Drunkard's Sailing Sampler	Exhibited-2 30x30, MOQ
<b>295</b>	Marion Emerson Autumn Leaves	Exhibited-2 20x45, MOQ
<b>296</b>	Elizabeth Stewart Golf-Cart Path Only	Exhibited-2 40x64, MOQ
<b>297</b>	Pat Weissensee Illusion	Exhibited-2 52x52, MOQ
<b>298</b>	Jackie Kelly Crazy Curves	Exhibited-2 40x60, MOQ
<b>299</b>	Deborah Ciarla, Quilter: Nancy Calhoun Good Times Bad Times	Exhibited-2 53x63
<b>300</b>	Kate Christiansen, Quilter: Angel Quilters Let's Go Boys!	Exhibited-9 52x66
<b>301</b>	Cindy Carroll, Quilter: Nancy Calhoun Evening Elegance	Judged-2 60x60
<b>302</b>	Jan Soules Stone Lakes	Judged-5 41x43
<b>303</b>	Linda Lawrence, Quilter: Lin Squires Yummy	Judged-2 53x70
<b>304</b>	Nancy Causey, Quilter: Marie Nelson Elliot's Tigers	Judged-10 54x60
<b>305</b>	Tiffany Poulson Draconian	Judged-5 42x49

<b>306</b>	Jane Magaw, Quilter: Debra Dolce Batik Sofa Quilt	Exhibited-2 60x82
<b>307</b>	Kate Christiansen, Quilter: Quilts by Cathy Snowpeople Friends	Exhibited-2 42x67
<b>308</b>	Roberta Burke, Quilter: Gina Boyd Bess in the Bower	Judged-9 36x39
<b>309</b>	Annette Salazar Hummingbird King	Judged-2 57x57
<b>310</b>	Lori Hemmingsen-Souza Harry Potter Bookcase Quilt	Judged-3 55x68
<b>311</b>	Vicky J Fong Mardi Gras	Judged-2 58x58
<b>312</b>	Janet A Van Wert, Quilter: Beth Lonnquist Mt. Lion	Judged-6 42x53
<b>313</b>	Elaine Mason, Quilter: David Hurd Australian Walkabout	Exhibited-2 59x68
<b>314</b>	Marylee Drake Color Explosion	Exhibited-2 35x43, MAQ
<b>315</b>	Lynn Tubbe Forsythia Spring - Hood River	Exhibited-6 53x37, MAQ
<b>316</b>	Julie Berry Aurora Borealis	Exhibited-6 33x20, MAQ
<b>317</b>	Michelle Peerson Serendipity Circles	Exhibited-5 34x35, MAQ
<b>318</b>	Carole Rossi Cathedral One	Exhibited-5 20x32, MAQ
<b>319</b>	Pat Gillings Martian Storm	Exhibited-5 26x32, MAQ
<b>320</b>	Jan Reed Going through the Change	Judged-3 20x25, MAQ
<b>321</b>	Linda Siska The World as One	Judged-6 28x48, MAQ
<b>322</b>	Jane Haworth Gentle Giant - Nubian Giraffe Calf	Judged-6 30x50, MAQ
<b>323</b>	Linda Siska Garden of the Goddess	Judged-6 20x28, MAQ
<b>324</b>	Trish Morris-Plise A River Runs Through It	Judged-5 27x34, MAQ
<b>325</b>	Jackie Manley Death Did Us Part	Judged-5 71x49, MAQ
<b>326</b>	Julie Berry Passing of Time	Exhibited-6 25x15, MAQ

<b>327</b>	Jan Reed End of the Drought	Exhibited-6 16x23, MAQ
<b>328</b>	Jan Reed Introspection - The Inner Journey	Exhibited-6 28x23, MAQ
<b>329</b>	Ginny Lee Croton Rendezvous	Exhibited-6 40x40, MAQ
<b>330</b>	Lynn Tubbe Face Time	Exhibited-6 20x22, MAQ
<b>331</b>	Jan Reed Shall We Dance?	Judged-3 28x39, MAQ
<b>332</b>	Ginny Lee We can do it!	Exhibited-6 42x49, MAQ
<b>333</b>	Karin Polli Return to the Reservation	Exhibited-6 38x41, MAQ
<b>334</b>	Ellen M Roberts, Quilter: Deborah Dolce Baskets - Block o'Month	Exhibited-3 33x33
<b>335</b>	Paulette Trafecanty, Quilter: Deborah Dolce Modern Mountains	Exhibited-2 53x64
<b>336</b>	Kristy Updegraff Sampler Quilt	Judged-2 98x108
<b>337</b>	Sharon Moos Northern Lights	Exhibited-2 56x68
<b>338</b>	Vicky J Fong Dancing Geisha	Judged-3 32x54
<b>339</b>	Kim Brownell Quilt Block Menagerie	Exhibited-10 34x50
<b>340</b>	Rita Lauchli Block of the Month - Joyful Baskets	Exhibited-3 42x43
<b>341</b>	RCQG Outreach Committee Quilter: Tonja McCarthy Eskaton Adult Day Health Center (Carmichael)	Exhibited-11 110x60
<b>342</b>	Carole Pirruccello Land Park	Exhibited-5 32x23
<b>343</b>	Sondra Lathe Anna's Flower	Exhibited-3 44x20
<b>344</b>	RCQG Members, Quilter: Korey J Chase RCQG Opportunity Quilt (2020)	Judged-11 72x96
<b>345</b>	RCQG Members, Quilter: Carole Mah RCQG Incentive Quilt (2019)	Exhibited-11 96x96

# Thistle Dew quilt shoppe



10127 Fair Oaks Blvd., Fair Oaks, CA 95628  
916-967-5479 [www.thistledewquiltshoppe.com](http://www.thistledewquiltshoppe.com)

Over 2,500 bolts of fabrics: quilting cottons, including batiks, solids, and contemporary prints; flannels, felted wool, dupioni silks, and more!

Largest selection of Sue Spargo wools and threads in Northern California. We also carry Cosmo embroidery floss and Sashiko threads, and many other beautiful embellishment threads, ribbons, and buttons.

Friendly expert staff

Great classes

Conveniently located in  
Old Fair Oaks Village



# Meissner

Sewing & Vacuum Centers

Northern California's  
Premiere Sewing, Quilting &  
Embroidery Destination

## LIFETIME EDUCATION

We offer new machine as well as creative classes and events for all skill levels and interests.

## FACTORY-TRAINED TECHNICIANS

Service & Repair by Certified Household and Industrial Sewing Machine & Technicians.

## EXTENSIVE MACHINE SELECTION

by top manufacturers of Household and Industrial Sewing and Embroidery Machines

## MEISSNER COMPLETE PROTECTION PLAN & LOW PRICE GUARANTEE

Buy with complete confidence!

## TOP-OF-THE-LINE VACUUMS

and Accessories by Miele, Dyson, Riccar and Oreck - Plus Vacuum Service & Repair



We are proud to be providing machines for the  
workshops at this year's Quilt & Fabric Art Festival.

*Ask an associate about special Festival pricing on workshop models!*

## COME VISIT OUR STORES:

### Sacramento

2417 Cormorant Way  
**(916) 920-2121**

### Santa Rosa

1455 Santa Rosa Ave.  
**(707) 575-5259**

### Folsom

98 Clarksville Rd. #130  
**(916) 984-7071**

### San Jose

4688 Meridian Ave.  
**(408) 264-4880**

### Roseville

9250 Fairway Dr. #110  
**(916) 791-2121**

#### STORE HOURS:

Monday-Friday 10-6  
Saturday 9-5  
Closed Sunday



brother  
at your side

BERNINA JANOME



PFAFF  
Perfection starts here™

Gammill

[www.MeissnerSewing.com](http://www.MeissnerSewing.com)

Meissner  
Sewing & Vacuum Centers

OFFER VALID:  
September 27-29, 2019

Save **\$100**  
on ANY MACHINE  
purchased over **\$1,000!\***

\*Offer good 9/27-29, 2019. Product selection varies by location. Coupon must be presented at time of purchase. Discount taken from MSRP. Not valid with any other offer or prior purchases. Limited to stock on hand. Some exclusions apply. See store for details.

Meissner  
Sewing & Vacuum Centers

OFFER VALID:  
September 27-30, 2019

**40% OFF** 1 Regular Priced  
Fabric Purchase\*  
Minimum 1 yard cuts

\*Offer good 9/27-30, 2019. Product selection varies by location. Minimum 1 yard cuts of fabric. Coupon must be presented at time of purchase. Discount taken from MSRP. Not valid with any other offer or prior purchases. Limited to stock on hand. Some exclusions apply. See store for details.